

TOTAL MILES	
Borough Road System	2.01 *
State Highway System	1.03
Total	3.04

* Includes ACT 32 Turnback Mileage of 0.26

POPULATION 147
(2000 Census)

LEGEND

	LIMITED ACCESS HIGHWAY
	STATE ROUTE AND NUMBER
	STATE MAINTAINED BRIDGE ON BOROUGH STREET
	BOROUGH STREET NAME AND SEGMENT LENGTH IN MILES
	TURNBACK BOROUGH STREET
	BOROUGH ALLEY
	OTHER ROAD
	RAILROAD
	STATE BOUNDARY
	COUNTY BOUNDARY
	TOWNSHIP BOUNDARY
	CITY BOUNDARY
	BOROUGH BOUNDARY
	MUNICIPAL BUILDING
	SPLIT MILEAGE BETWEEN MUNICIPALITIES
	SCHOOL, COLLEGE OR UNIVERSITY
	POINT OF INTEREST



HOMEWOOD BOROUGH

BEAVER COUNTY

PREPARED BY THE

PENNSYLVANIA DEPARTMENT OF TRANSPORTATION

BUREAU OF PLANNING AND RESEARCH
GEOGRAPHIC INFORMATION DIVISION

IN COOPERATION WITH THE

U.S. DEPARTMENT OF TRANSPORTATION
FEDERAL HIGHWAY ADMINISTRATION

AND

MUNICIPAL SERVICES DISTRICT 11-0

MUNICIPAL CODE 04 417

REVISED PER FORM 990 DATED 2-6-98

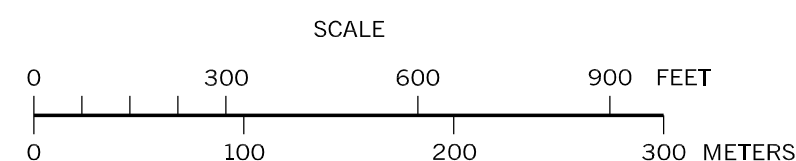
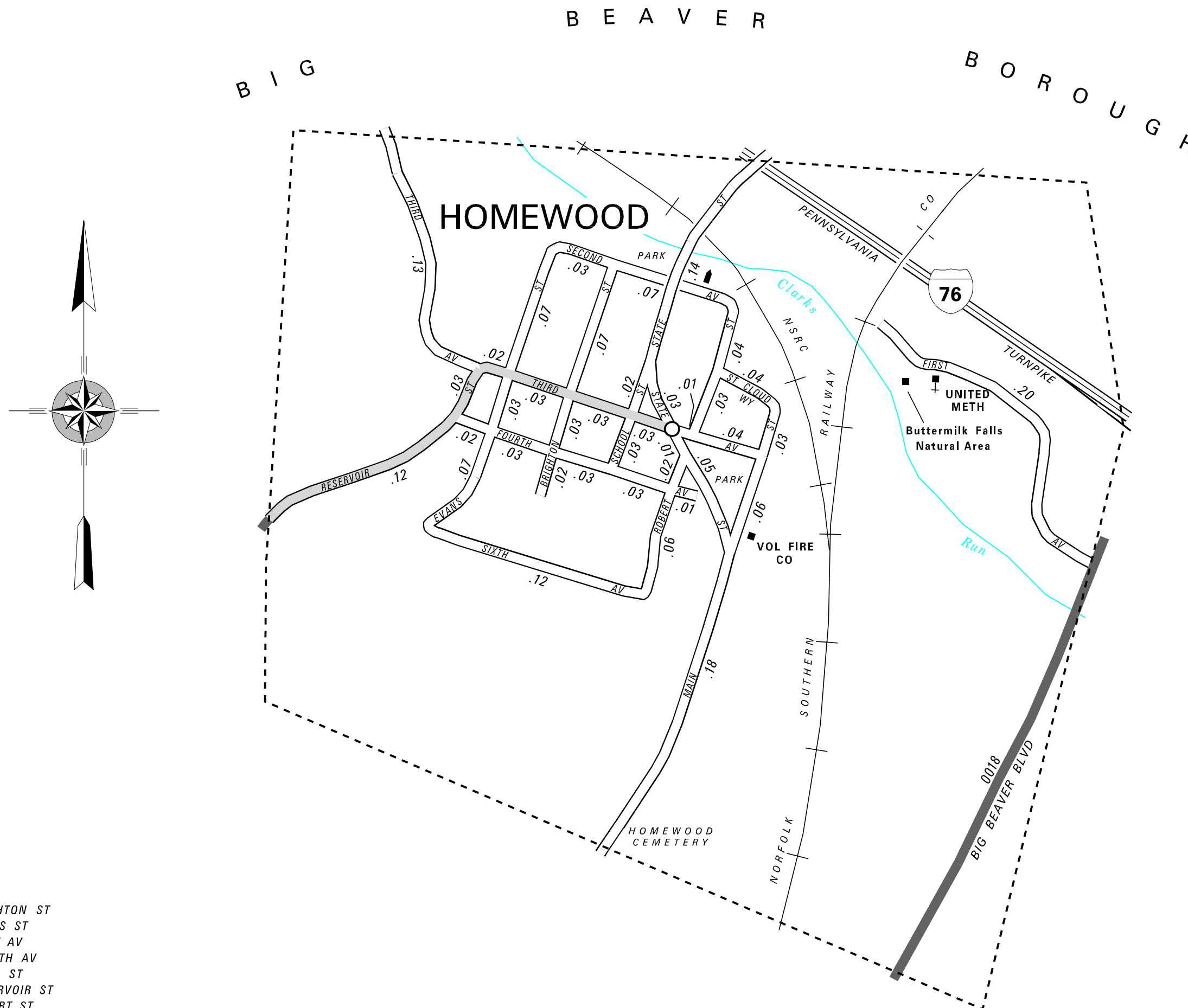

BRIGHTON ST
EVANS ST
FIRST AV
FOURTH AV
MAIN ST
RESERVOIR ST
ROBERT ST
SCHOOL ST
SECOND AV
SIXTH AV
ST CLOUD WY
STATE ST
THIRD AV