

LEGEND

	LIMITED ACCESS HIGHWAY
	STATE ROUTE AND NUMBER
	STATE MAINTAINED BRIDGE ON TOWNSHIP ROAD
	TOWNSHIP ROAD, NUMBER AND SEGMENT LENGTH IN MILES
	IMPASSABLE TOWNSHIP ROAD
	OTHER ROAD
	RAILROAD (IN SERVICE)
	RAILROAD ABANDONED (TRACK RETAINED)
	STATE BOUNDARY
	COUNTY BOUNDARY
	TOWNSHIP BOUNDARY
	CITY OR BOROUGH BOUNDARY
	MUNICIPAL BUILDING
	SPLIT MILEAGE BETWEEN MUNICIPALITIES

POPULATION 74
(2020 Census)

TOTAL MILES	
Township Road System	<u>2.85</u>
State Highway System	<u>5.51</u>
Total	<u>8.36</u>

COPIES OF THIS MAP ARE AVAILABLE AT NOMINAL COST
CONTACT:

PENNSYLVANIA DEPARTMENT OF TRANSPORTATION
SALES STORE
P.O. BOX 3451
HARRISBURG, PENNSYLVANIA 17105-3451
TELEPHONE: (717) 787-6746

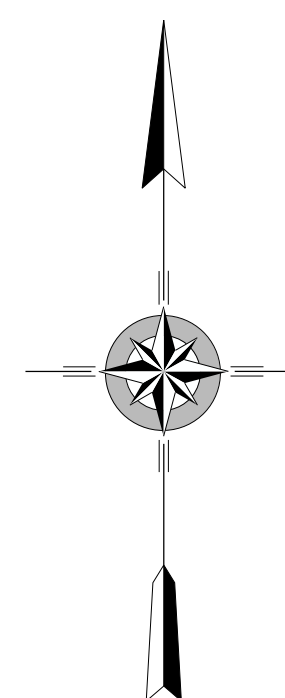
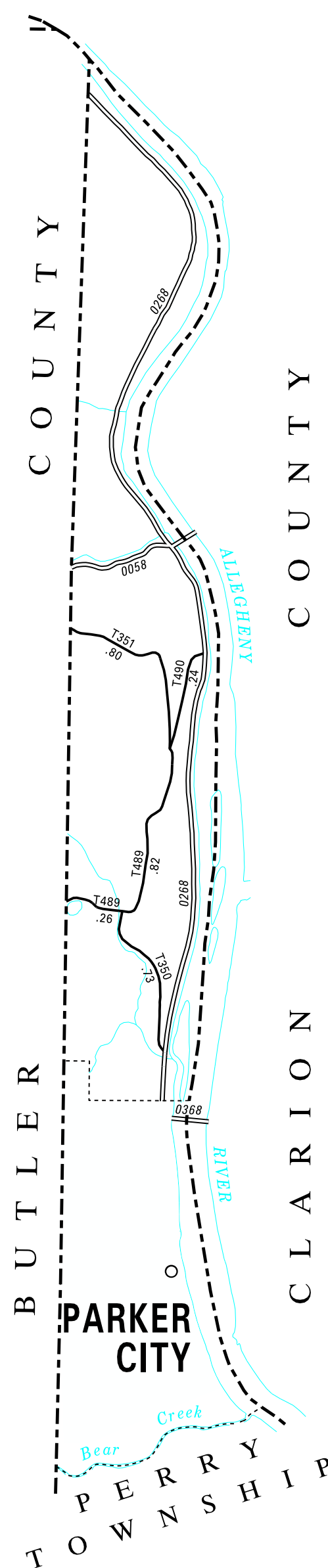

HOVEY
SECOND CLASS TOWNSHIP MAP
ARMSTRONG COUNTY

PREPARED BY THE
PENNSYLVANIA DEPARTMENT OF TRANSPORTATION

BUREAU OF PLANNING AND RESEARCH
GEOGRAPHIC INFORMATION DIVISION

IN COOPERATION WITH THE
U.S. DEPARTMENT OF TRANSPORTATION
FEDERAL HIGHWAY ADMINISTRATION

MUNICIPAL CODE 03 209

THIS MAP IS PUBLISHED AS A SUPPLEMENTAL
DOCUMENTATION OF LIQUID FUELS TAX FUND MILEAGES
REVISED PER FORM 990 DATED 2-28-00

SCALE

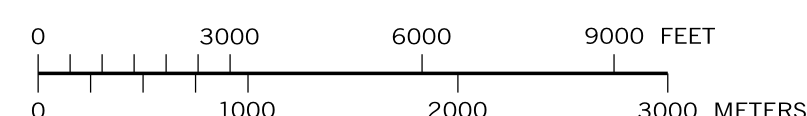

350 BENNERTOWN RD
351 COALBANK RD
489 ROBINSON RD
490 GREENHILL RD