

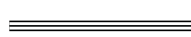

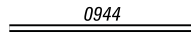

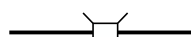

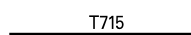





LEGEND

-  LIMITED ACCESS HIGHWAY
-  STATE ROUTE AND NUMBER
-  STATE MAINTAINED BRIDGE ON TOWNSHIP ROAD
-  TOWNSHIP ROAD, NUMBER AND SEGMENT LENGTH IN MILES
-  IMPASSABLE TOWNSHIP ROAD
-  TURNBACK TOWNSHIP ROAD
-  OTHER ROAD
-  RAILROAD (IN SERVICE)
-  RAILROAD ABANDONED (TRACK RETAINED)
-  STATE BOUNDARY
-  COUNTY BOUNDARY
-  TOWNSHIP BOUNDARY
-  CITY OR BOROUGH BOUNDARY
-  MUNICIPAL BUILDING
-  SPLIT MILEAGE BETWEEN MUNICIPALITIES

POPULATION 3,816
(2020 Census)

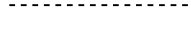
- 401 MARITIME DR
- 402 CENTER DR
- 403 WATERWAY DR
- 405 TARTTOWN RD
- 416 DEER RUN RD
- 418 CRESSMAN RD
- 424 WYANT RD
- 425 ELM DR
- 426 MAPLE LA
- 428 OAK DR
- 429 LOCUST LA
- 430 TOY RD
- 433 JOHNS RD
- 434 SMITH RD
- 436 ROLLING HILLS RD
- 437 CEDAR DR
- 438 PENCE RD
- 443 J BOWSER RD
- 416 ADRIAN RD
- 480 FRENCHS CORNER RD
- 481 GLACIAL SAND RD
- 482 FINE CLAYPOOL RD
- 495 BOUCH RD
- 497 BEVINGTON RD
- 499 RIDGE RD
- 501 BOLTZ RD
- 504 MIDWAY ST
- 505 FURNACE RUN RD
- 506 WIBLE RD
- 507 NORTH WIBLE RD
- 508 UPPER FURNACE RUN RD
- 509 SHAY RD
- 510 PARKVIEW DR
- 511 PARKVIEW DRIVE EXT
- 512 COAL S
- 513 CHERRY ORCHARD AV
- 514 WINTER ST
- 515 WATERWORKS ST
- 520 ROBIN DR
- 521 CHICKADEE DR
- 522 ORIOLE WY
- 523 WOODPECKER DR
- 524 CARDINAL DR
- 530 PLEASANT VIEW DR
- 531 SOTOS RD
- 600 MANDOR LA
- 601 BLACKTHORN DR
- 602 EAGLES NEST DR
- 603 ALPINE WOODS DR
- 604 ALPINE LN
- 605 PINE ST
- 606 CAMPBELL DR
- 608 SOUTH ST
- 609 CHERRY TREE LA
- 651 WOODLAND DR
- 652 TRIN LAKES DR
- 655 SUNSET DR
- 656 MONTEREED ST
- 657 WILBAR AL
- 661 HENRIK DR
- 670 FRICK RD
- 680 SLAN RD
- 681 BOOMER RD
- 704 WALNUT BOTTOM DR
- 709 SHERWOOD DR
- 740 CARPENTER DR
- 741 RAINBOW DR
- 742 PINEWOOD ST
- 743 BENNETT DR
- 745 WESTGATE DR
- 757 MAPLE DR
- 758 SHERIDAN DR
- 759 BRIAR HILL RD
- 760 NORTH PARK DR
- 763 GLADE PARK DR
- 767 NOLTE DR
- 768 SOUTH PARK DR
- 769 WEST PARK DR
- 770 WESTMONT DR
- 771 CHARLOTTE CIR
- 772 LAURA LA
- 773 LONGVIEW DR
- 858 KEN WOLFE RD
- 880 LEWON HOLLOW RD
- 881 FLEEGER RD
- 970 WILLOW DR
- 980 FAHLOR RD
- 981 MONTGOMERY RD
- 982 QUIGLEY RD
- 983 WALKCHALK RD
- 990 COMMERCE DR
- 991 HERITAGE PARK DR
- 992 PRESTON LA

COPIES OF THIS MAP ARE AVAILABLE AT NOMINAL COST
CONTACT:
PENNSYLVANIA DEPARTMENT OF TRANSPORTATION
SALES STORE
P.O. BOX 3451
HARRISBURG, PENNSYLVANIA 17105-3451
TELEPHONE: (717)787-6746

TOTAL MILES	
Township Road System	56.81*
State Highway System	34.86
Total	91.67

* Includes ACT 32 Turnback Mileage of 12.18

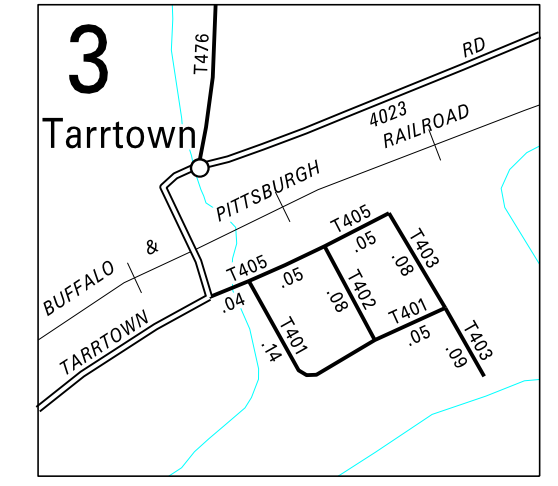
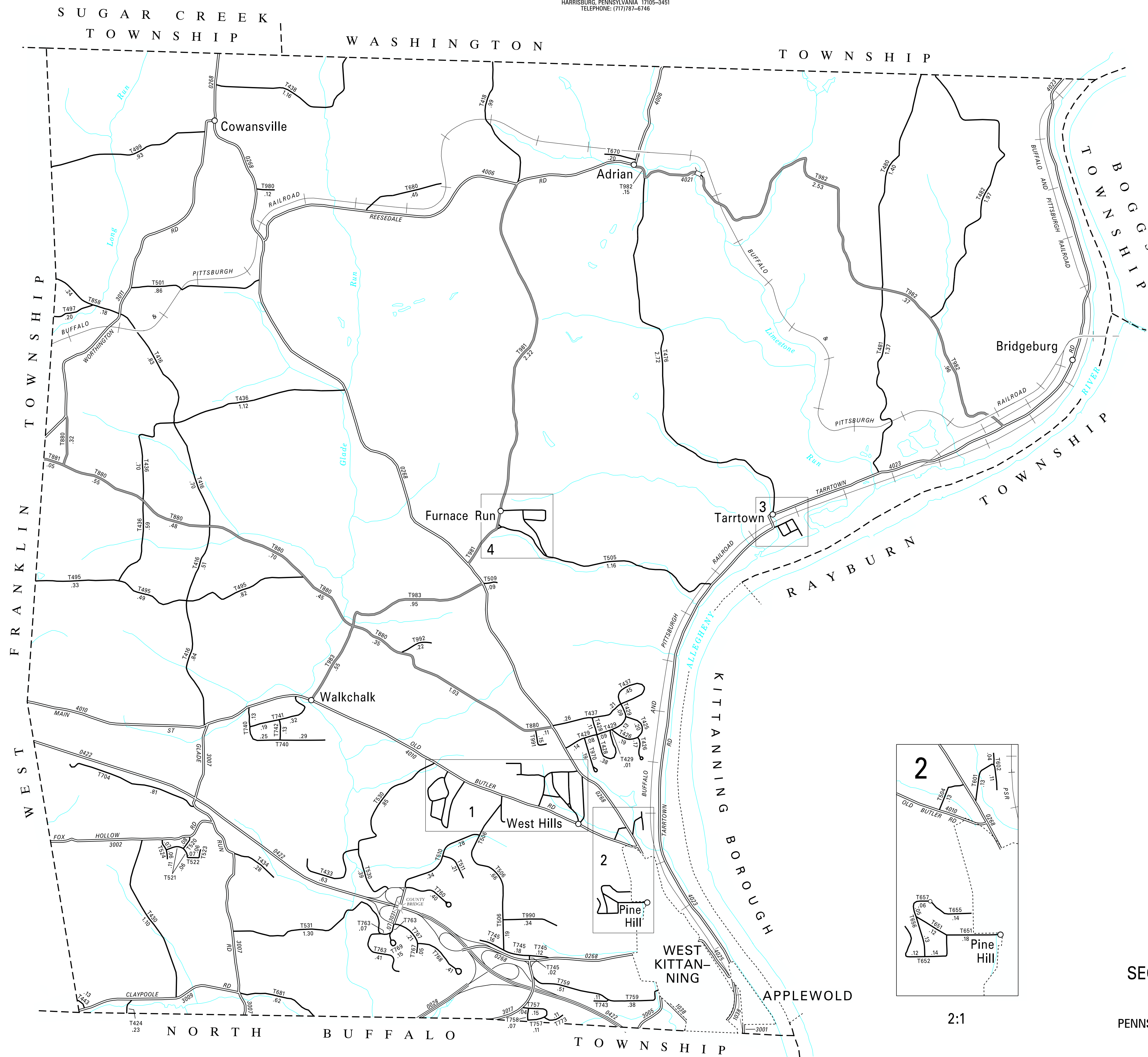

3:1

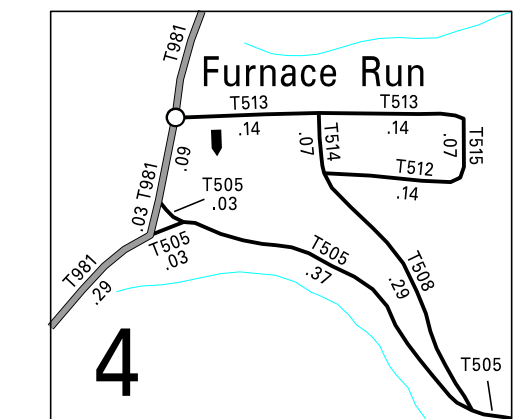

2:1

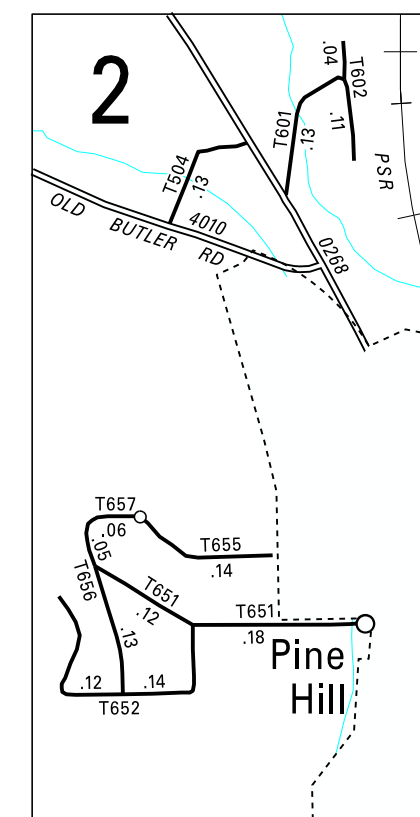

2:1

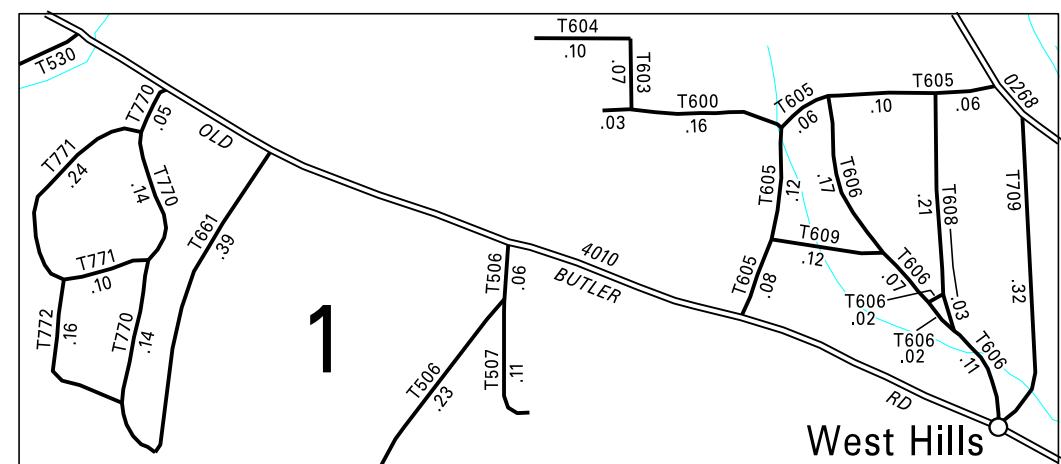

2:1

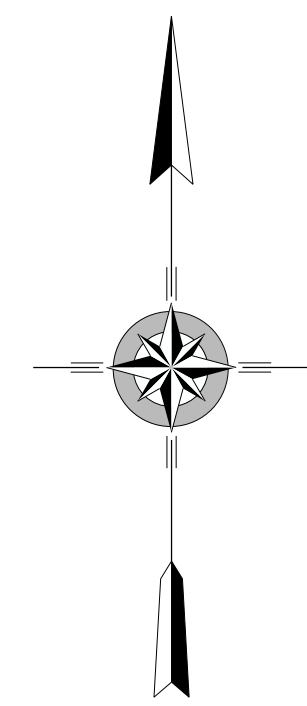

**EAST FRANKLIN
SECOND CLASS TOWNSHIP MAP
ARMSTRONG COUNTY**

PREPARED BY THE
PENNSYLVANIA DEPARTMENT OF TRANSPORTATION
BUREAU OF PLANNING AND RESEARCH
GEOGRAPHIC INFORMATION DIVISION
IN COOPERATION WITH THE
U.S. DEPARTMENT OF TRANSPORTATION
FEDERAL HIGHWAY ADMINISTRATION

MUNICIPAL CODE 03 207
THIS MAP IS PUBLISHED AS A SUPPLEMENTAL
DOCUMENTATION OF LIQUID FUELS TAX FUND MILEAGES
REVISED PER FORM 990 DATED 2-27-25

